

## SYSTEM ACCESSORIES

CHOOSING THE RIGHT MEMBRANE FOR  
FOUNDATIONS AND BASEMENTS

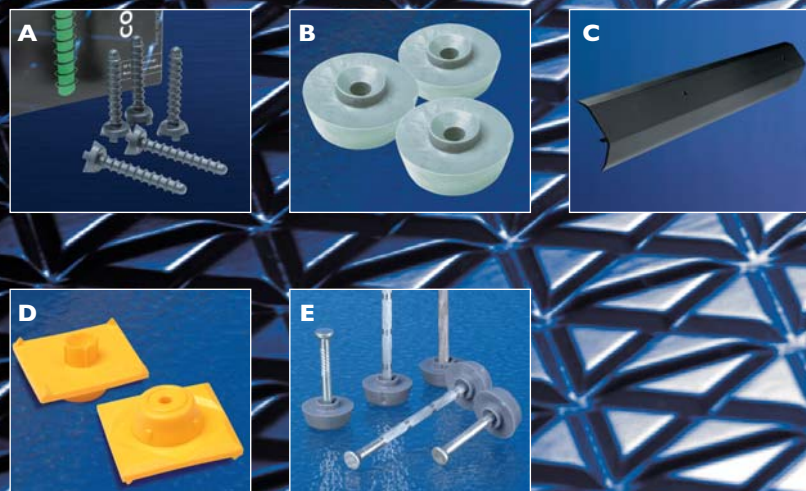

- A. Concrete plugs
- B. Plugs for nails
- C. Finishing profile for Oldroyd
- D. Gun plugs
- E. Steel nails with plugs

Oldroyd supply a complete range of  
accessories to ensure a perfect finish.

For more information please visit  
our website.

[www.oldroyd.com](http://www.oldroyd.com)

Product safety information is available on request. The Information corresponds to our current knowledge on the subject. It is offered solely to provide possible suggestions for your own requirements. It is not intended, however, to substitute any testing you may need to conduct to determine for yourself the suitability of our products for your particular purposes. This information may be subject to revision as new knowledge and experience becomes available. Since we cannot anticipate all variations in actual end-use conditions, Oldroyd makes no warranties and assumes no liability in connection with any use of this information. Nothing in this publication is to be considered as a license to operate under or a recommendation to infringe any patent right.

FB/06/07 © OLDROYD AS 2007

## FOUNDATIONS AND BASEMENTS

CHOOSING THE RIGHT MEMBRANE FOR  
FOUNDATIONS AND BASEMENTS

We have invested a great deal of time and  
resources into establishing working practices to  
ensure a consistent and measurable quality in all  
of our products.

Our quality procedures are far in excess of the  
standards demanded by current regulations.

Care of the environment is of great importance  
to us. We have recently developed our new  
multi-layer technology to maximise the use of  
recycled material in manufacturing and  
environmental routines have been introduced and  
integrated into existing ISO systems.



The company possesses the following ISO Certificates:  
**NS-EN ISO 9001:2000** and **European Environmental  
Management System NS-EN ISO 14001**



Oldroyd AS  
Kragere Næringspark, 3766 Sannidal, Norway  
Tel: +47 35 98 75 50 Fax: +47 35 98 75 51  
E-mail: [oldroyd@oldroyd.com](mailto:oldroyd@oldroyd.com)

[www.oldroyd.com](http://www.oldroyd.com)

## FOUNDATIONS AND BASEMENTS

CHOOSING THE RIGHT MEMBRANE FOR  
FOUNDATIONS AND BASEMENTS

- Multi-Layer Technology  
provides increased strength.
- Specifically designed for  
use in foundations.
- Minimal preparation  
needed.
- 50 year guarantee.

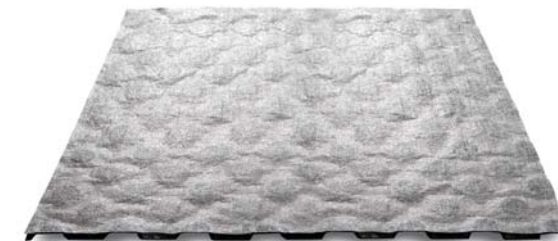

Xv MEMBRANE PROTECTS AGAINST SULPHATES, RADON AND MOISTURE

Gtx MEMBRANE PROTECTS FOUNDATION WALLS FROM GROUNDWATER

Gtx 10 MEMBRANE FOR HIGH LOAD AND DRAINAGE

Gtx 20 MEMBRANE WITH VERY HIGH DRAINAGE CAPACITY

Xs MEMBRANE FOR WATERPROOFING PROTECTION OF FOUNDATION SLABS

ACCESSORIES AND SPECIFICATIONS





# OLDROYD Xv

PROTECTS AGAINST GROUNDWATER, SULPHATES  
AND RADON AND ALLOWS CONSTRUCTIONAL  
MOISTURE TO ESCAPE

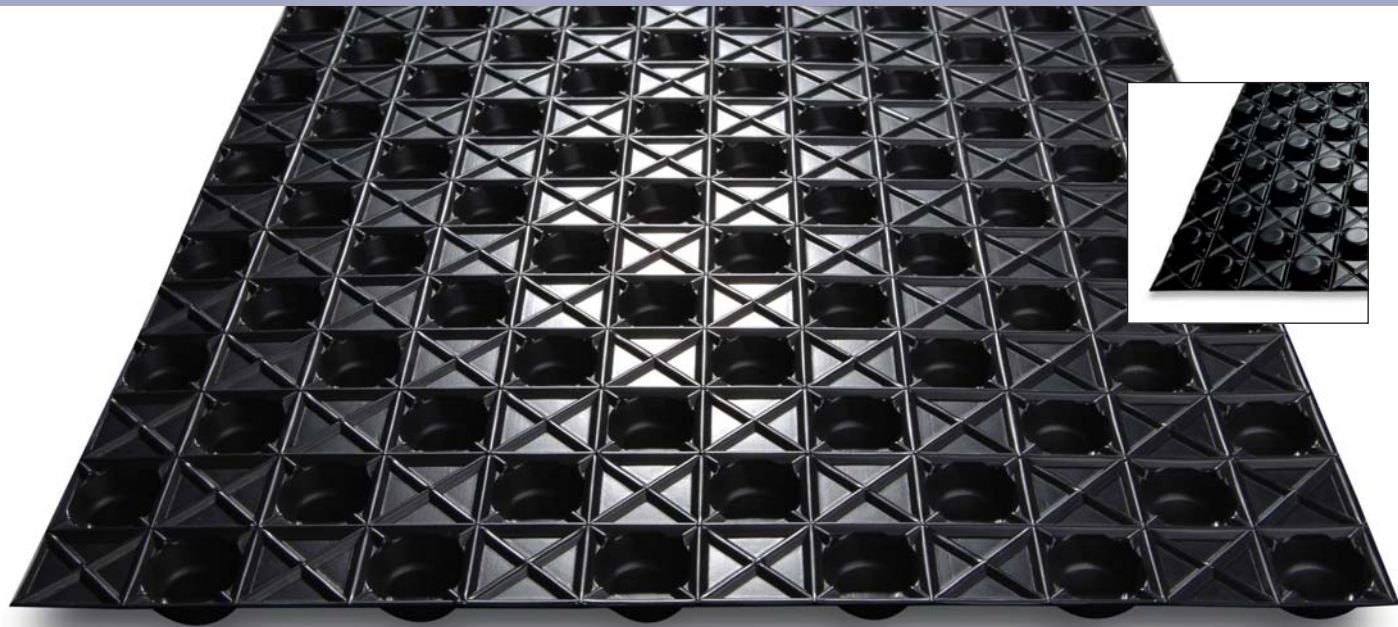

In below-ground waterproofing applications, the primary function of Oldroyd Xv is to divert water away from the basement walls. When used in conjunction with Oldroyd sealing tapes, Oldroyd Xv can act as a barrier against ground gases, such as methane and radon.

The main component of the Oldroyd Xv system is a membrane with a thickness of 0.5mm and a characteristic pattern of studs and channels. It is resistant to all chemicals normally found in the soil. When used as part of an externally applied basement waterproofing system, Oldroyd Xv is used in conjunction with an appropriate drainage aggregate. Where this is not possible, the use of Oldroyd Gtx membrane should be considered.

The Multi-Layer Technology of Oldroyd Xv results in a membrane with greater strength than normal studded membranes, and allows the use of recycled material in the central layer.



When used in conjunction with Oldroyd sealing tapes, Oldroyd Xv can be used to create a barrier that is impregnable to ground gases and contaminants as well as ground water.

THE FLEXIBLE, FAST AND COST-EFFECTIVE  
ANSWER TO MOISTURE IN FOUNDATIONS  
AND BASEMENTS

Xv

## KEY FEATURES: OLDROYD Xv

- Cost-effective, fast and safe installation. Made from polypropylene, it is easy to work with even at low temperatures.
- Unique design makes it easy to apply around corners and over footings.
- Consistent material thickness of membrane and stud gives great strength.
- Fixings to fit the studs and finishing profile provide secure and neat fastening.
- Multi-Layer Technology gives superior strength.



## RAPID FIXING

Oldroyd Xv can be applied to concrete using the unique Oldroyd Gun Plug, providing an accurate, safe and easy means of fixing.



## TYPICAL APPLICATIONS

- Newbuild basements
- Buildings built into hillsides
- Ground Gas applications



# The OLDROYD Gtx range

A NEW REVOLUTIONARY STUDDED MEMBRANE RANGE  
WITH A WELDED GEOTEXTILE

THE FAST AND COST-EFFECTIVE  
ALL IN ONE WELDED GEOTEXTILE MEMBRANE RANGE

**Gtx**  
range

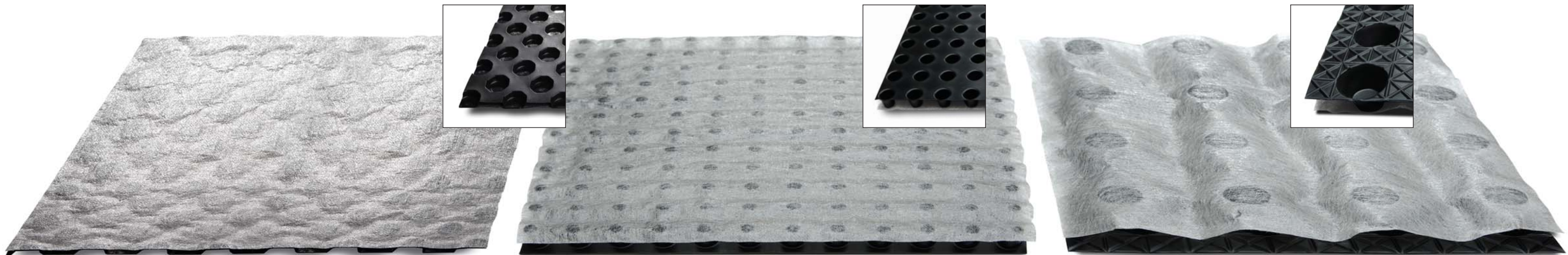

## Gtx

THE NEW  
'WRAPAROUND'™  
GEOTEXTILE MEMBRANE  
TO PROTECT  
FOUNDATION WALLS  
FROM GROUNDWATER  
AND SIGNIFICANTLY  
REDUCE BLOCKAGE OF  
LAND DRAINS

## Gtx10

(High Compressive Strength)

DESIGNED TO  
COMBAT PROBLEMS  
ENCOUNTERED WITH  
HIGHER LOADS WHEN  
WATERPROOFING  
DEEP FOUNDATIONS

## Gtx20

(High Flow Rate)

DESIGNED FOR USE  
WHERE HIGHER  
FLOW RATES ARE  
ANTICIPATED

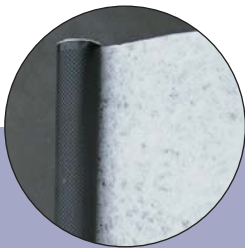

### NEW FROM OLDROYD!

The revolutionary new Oldroyd Gtx Range of studded membranes with a welded geotextile provides an extremely easy to use barrier to protect against ground water. The welded geotextile ensures it will not easily separate and will not slip in use over time.

In many cases using Oldroyd Gtx membranes can eliminate the need to include a draining aggregate layer - thus allowing the membrane to be backfilled using excavated soil.

The membrane in Oldroyd Gtx incorporates Multi-Layer Technology giving improved strength and allowing the use of recycled material in the central layer, benefiting the environment.

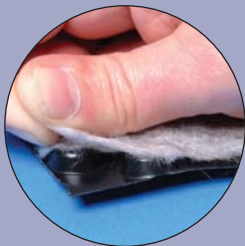

### THE MOST EFFECTIVE FOUNDATION PROTECTION SYSTEM

Gtx



Gtx 10 High Load



Gtx 20 High Flow Rate





# OLDROYD Gtx

THE NEW WRAPAROUND™ GEOTEXTILE MEMBRANE TO PROTECT FOUNDATION WALLS FROM GROUNDWATER AND SOIL CONTAMINANTS

Unlike many other geotextile membrane products, Oldroyd Gtx is an all in one easy to use product with the geotextile welded to the membrane to ensure a permanent bond. It takes away the need to apply separate rolls of geotextile material to prevent particles from obstructing or blocking the drainage cavity.

Oldroyd Gtx is now available with the option of having the geotextile in Wraparound™ format making it even easier to use around drainage pipes.



A NEW CONCEPT MEMBRANE DESIGNED TO DRAIN & FILTER WATER AWAY FROM BACK-FILLED WALLS PROVIDING THE OPTION TO USE INSULATION EXTERNALLY

Gtx  
range

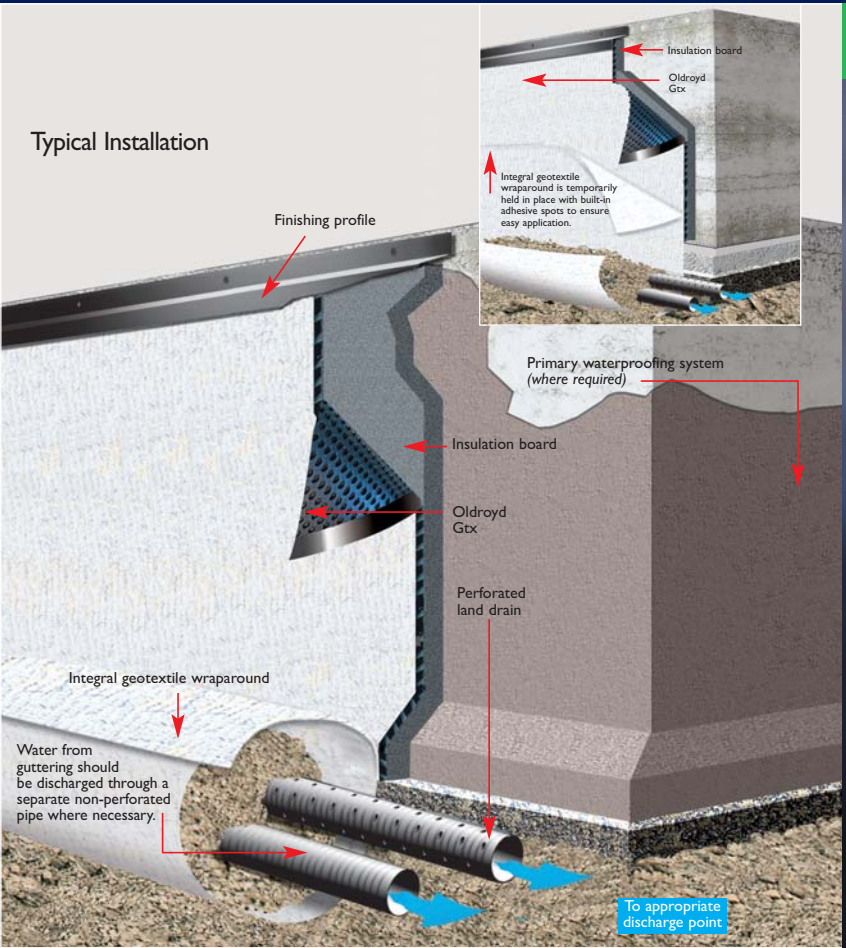

## KEY FEATURES: OLDROYD Gtx

- Studded membrane with a welded geotextile for permanent bonding.
- Allows backfilling with excavated earth.
- Resistant to all chemicals normally found in the ground.
- The ideal membrane to use in combination with insulation board.
- The most effective way to prevent blockage to drainage pipes.
- Withstands stress and movement.
- The geotextile wraparound edging can be simply peeled away for easy fixing.
- Extremely strong, minimising the risk of damage when backfilling.
- Recycled material in central layer of membrane.



# Wraparound™

Patent Applied For

The Oldroyd Gtx range is now available featuring a unique new Wraparound™ geotextile (patent applied for). This makes it even easier to install and ensures that the land drain will function effectively over a long period of time.

The welded geotextile provides permanent bonding ensuring it will not easily separate and isn't subject to slipping over time with use.



## TYPICAL APPLICATIONS

- Deep level foundations
- Newbuild basements



# OLDROYD Gtx10/Gtx20

DESIGNED TO COMBAT PROBLEMS ENCOUNTERED WITH  
HIGHER LOAD BEARING AND HIGHER DRAINAGE NEEDS

High Load



Oldroyd Gtx10

High Flow Rate



Oldroyd Gtx20

Oldroyd Gtx10 and Gtx20 are similar to the regular Gtx membrane with the benefit of a welded geotextile, but feature larger studs tailored to suit the problems encountered with high load bearing and higher drainage requirements.

The dense stud pattern of Oldroyd Gtx10 provides increased compressive strength compared with the regular Oldroyd Gtx membrane. Its primary function is to protect deep level foundations from external moisture and walls from the ingress of ground water.

Oldroyd Gtx20 is designed to be used to filter and drain water away from backfilled walls and to permit the use of external insulation. With 20mm studs, Gtx20 provides a barrier to protect walls from ground water and is used to provide high capacity drainage underneath concrete floors in buildings, parking lots etc.



Oldroyd Gtx10 and Gtx20 both feature Multi-Layer Technology with the benefits of extra strength and recycled material in the central layer.

WELDED GEOTEXTILE  
MEMBRANES SUITABLE FOR  
HIGHER LOAD BEARING OR  
HIGHER DRAINAGE CAPACITY

Gtx  
range

## KEY FEATURES: OLDROYD Gtx10

- Studded membrane with a welded geotextile for permanent bonding.
- Allows backfilling with excavated earth.
- Resistant to all chemicals normally found in the ground.
- Greater resistance to load and stress than Oldroyd Gtx.
- Suitable for applications requiring a higher drainage capacity.
- Extremely strong, minimising the risk of damage when backfilling.
- Recycled material in central layer of membrane.

## KEY FEATURES: OLDROYD Gtx20

- Studded membrane with a welded geotextile for permanent bonding.
- Allows backfilling with excavated earth.
- Resistant to all chemicals normally found in the ground.
- Designed specially to cope with situations requiring a very high drainage capacity.
- Extremely strong, minimising the risk of damage when backfilling.
- Recycled material in central layer of membrane.



## TYPICAL APPLICATIONS OLDROYD GTX10

- Deep level foundations

## TYPICAL APPLICATIONS OLDROYD GTX20

- High drainage capacity under concrete floors
- Sustainable Urban Drainage Systems (SUDS)



# OLDROYD Xs

PROVIDES WATERPROOFING PROTECTION AND A GROUND  
GAS BARRIER FOR FOUNDATION SLABS

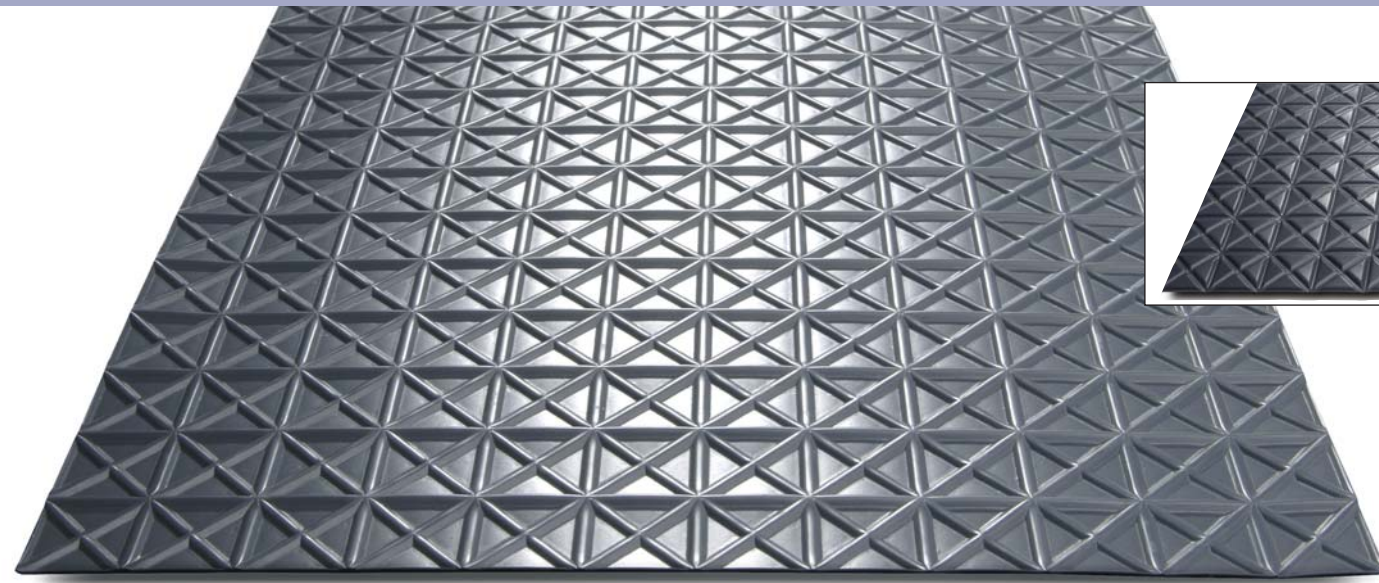

Oldroyd Xs is much thicker than conventional damp-proofing membranes and is manufactured from polypropylene. This makes it extremely strong and gives it a high resistance to damage and offers resistance to all chemicals normally found in the ground. The patented 'X' pattern embossed into the membrane makes it easy to cut and fold around complex constructional details and allows for drying shrinkage when concrete is laid on top, reducing the risk of cracking.

As well as protecting against dampness and water ingress, Oldroyd Xs can also provide protection against ground gases such as radon.



THE FLEXIBLE, FAST AND COST-EFFECTIVE  
TO WATERPROOF FOUNDATION SLABS

## Xs

### KEY FEATURES: OLDROYD Xs

- A tough damp-proofing membrane that can be laid on top of damp concrete floors or newly laid floor slabs.
- Protects against moisture and soil contaminants.
- Multi-Layer Technology gives superior strength.
- Recycled material in central layer.
- Easy to join using Oldroyd sealing tape.

"Double Sealing" detail required when Oldroyd Xs is used as part of a ground gas protection system.

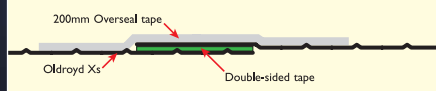

### TYPICAL APPLICATIONS

- Slab protection below ground
- Ground gas protection



## THE UNIQUE BENEFITS OF OLDROYD

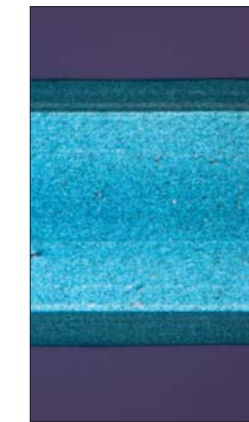

Through a microscope (above), the quality of the technology employed in the manufacturing process can be clearly seen in this cross-section.

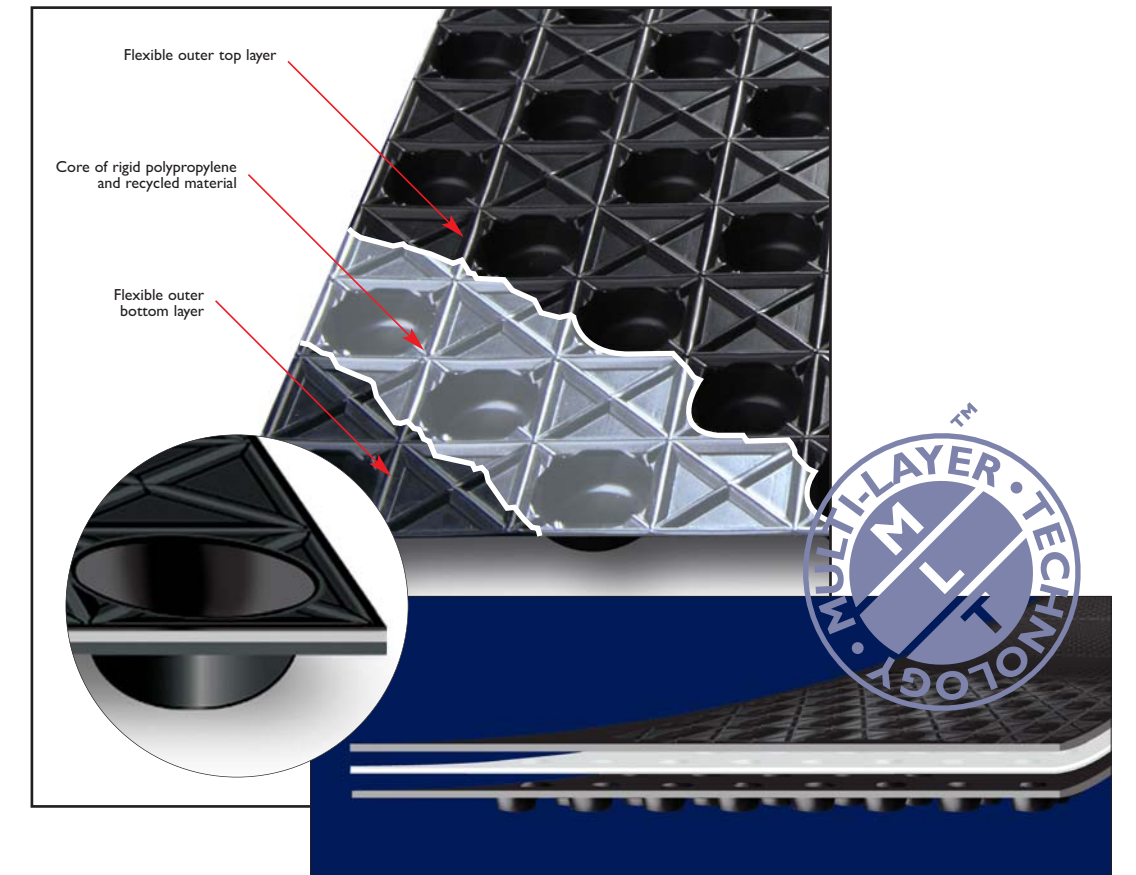

The Oldroyd range of membranes for basements and foundations feature unique properties making them the best choice for superior performance and ease of use.

Oldroyd membranes are manufactured in Norway and are designed to excel in the harsh Scandinavian climate.

- Multi-Layer Technology™ featuring an inner core made from rigid polypropylene and recycled material, enhancing structural integrity and benefiting the environment.
- Unique 'X' pattern makes the membrane easier to work with, cutting and folding around complex constructional details and corners is much simpler than with conventional membranes.
- Available in a variety of widths and lengths.
- 50 Year Product Guarantee.
- The manufacturing process complies with NS-EN ISO 9001:2000 and European Environmental Management System NS-EN ISO 14001.