

## ...Why use them?

- Faster build time, saving you money
- Eliminate cutting & reduce waste
- Compliance with Building Regulations
- Avoid cold bridging
- Protect against pattern staining
- Cavity closing at reveals and eaves level
- Eliminate expensive cavity closers
- In-fill around doors and windows
- Coursing at floor and ceiling level
- Making up between joists

Thermalite offers you a FREE Technical Advisory Service dedicated to providing technical recommendations, including SAP calculations, to satisfy Building Regulations requirements.

For more information on all Thermalite products, or for Technical Advice, please contact us on:

Phone: 08705 626500

Fax: 08705 626550

E-mail: [tas-thermalite@mbm-marley.co.uk](mailto:tas-thermalite@mbm-marley.co.uk)

**THERMALITE**

[www.thermalite.co.uk](http://www.thermalite.co.uk)

Marley Building Materials,  
Station Road, Coleshill, Birmingham B46 1HP

Tel: 01675 468400

Fax: 01675 468455

E-mail: [thermalite@mbm-marley.co.uk](mailto:thermalite@mbm-marley.co.uk)

**THERMALITE**

## Coursing Bricks



# Coursing Bricks

# THERMALITE

Building a sustainable future

Thermalite is the leading name in building blocks in the United Kingdom, having pioneered autoclaved aerated concrete over 50 years ago.

Thermalite Coursing Bricks were first developed in response to builders' needs for a brick-sized product that would improve build time and eliminate the need for cutting – saving time and money.

As with other Thermalite products, Coursing Bricks are also extremely environmentally friendly, being made from over 50% pulverised fuel ash (a waste product) and their use can significantly reduce energy consumption and environmental damage.

The use of Coursing Bricks, in conjunction with other Thermalite blocks, enables builders to comply with Building Regulations, by ensuring that a uniform material is used across the wall. In fact, Building Control Officers will insist that a wall is upgraded if it does **not** achieve a uniform thermal performance.



Coursing Bricks can be used as in-fill around doors and windows to avoid cold bridging and protect against pattern staining on internal walls.

## PRODUCT DATA

### Face dimensions (mm)

215 x 65

### Brick thickness (mm)

100, 115, 125, 130

Thermalite Coursing Bricks are suitable for use externally and internally, above or below d.p.c level in loadbearing or non-loadbearing applications.

Loadbearing walls should not be constructed with Coursing Bricks as the sole masonry unit.

Additionally, standard Coursing Bricks should not be used in walls where the compressive strength requirement for the blockwork is in excess of 4N/mm<sup>2</sup>.

Hi-Strength Coursing Bricks are available as a made to order item for projects where walls are built using Thermalite Hi-Strength 7 blocks (7N/mm<sup>2</sup>).

The high level of thermal performance achieved allows them to be used for closing the cavity around windows, doors and at eaves level, eliminating the need for expensive cavity closers.

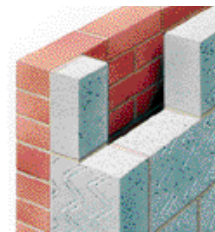

In addition to these benefits, Thermalite Coursing Bricks can also be used for making up between joists.